

Jodale • Perry Corporation

P.O. Box 909

300 Route 100

Morden, Manitoba, Canada

R6M 1A8

Ph: (204) 822-9100

Fax: (204) 822-9111

Email: admin@jodaleperry.com

Operator's Manual

This manual must remain with the BOXER cab:

Serial #: _____

**If it is stolen, lost, or misplaced, contact Jodale Perry
for an immediate replacement prior to operating the tractor.**

Deere Gator

BOXER Cab

Printed in Canada: 2002/03

1.0 Introduction

We at Jodale Perry are pleased that you have chosen a BOXER cab for your Deere Gator Utility Vehicle. The BOXER cab has evolved through ideas and suggestions submitted to us by customers such as yourself.

We ask that you study this manual and adopt the practices outlined in it.

We ask that for practices and operations not outlined in this manual, you follow the instructions given in the operator's manual supplied with the tractor. Before putting the tractor in service, become familiar with all the information described in both manuals.

Tractor in this manual is defined as the vehicle mounted with BOXER cab (i.e. tractor, mower, utility vehicle, etc.)

2.0 Safety

Carefully review the procedures given in this manual and the tractor operator's manual with all operators annually. It is important that all operators be familiar with, and follow, safety precautions.

Operating instructions must be given to everyone using the tractor before operation and at least once yearly thereafter in compliance with OSHA Regulations 1928.57 (United States).

2.1 General Safety

2.1.1. Never let an unqualified or untrained driver operator operate the tractor.

2.1.2. Keep a fire extinguisher, with ABC rating securely fastened in the cab. Maintain it and be familiar with its use.

2.1.3. Never carry passengers.

2.1.4. Never operator the tractor in a closed building. Provide adequate ventilation. Engine exhaust fumes are poisonous and can kill.

2.1.5. Always keep sleeves, jackets, or other clothing relatively tight, and belted. Loose clothing may catch in moving parts, and result in personal injury or death.

2.1.6. Provide a first-aid kit, securely attached in the cab for use in case of accident.

2.1.7. Never jump from the tractor. There is a danger of catching clothing on protruding parts.

2.1.8. Use steps and handholds when mounting and dismounting the tractor, or for servicing components too high to reach from the ground.

2.1.9. Do not use the cab fender as a step.

2.1.10. Safety devices and shields are intended to protect operators from injury or death. Under no circumstances should they be disabled or removed.

2.2 Operating Safety

2.2.1. Always operate the tractor controls while sitting in the operator's seat.

2.2.2. Avoid abrupt turns, starts, or stops, especially at high speeds.

2.2.3. Keep all shields in place when operating the tractor.

2.2.4. Do not operate the tractor when you are tired, sick, or impaired.

2.2.5. Never operate the tractor in confined areas; visibility next to the tractor is reduced. Injury to bystanders, or damage to the cab or equipment may result.

2.3 Safe Operation in Rough Terrain

2.3.1. Drive the tractor slowly on hillsides and curves to eliminate the danger of tipping. Avoid slopes which are too steep for safe operation. Avoid sharp uphill turns.

2.3.2. Always drive slowly over rough ground or obstructions. Drive at speeds slow enough to ensure your safety.

2.3.3. When driving out of a ditch, gully, or up a steep hillside, engage the clutch slowly. Avoid sharp uphill turns.

2.3.4. When descending steep grades, select a sufficiently low gear to maintain control with minimum braking.

2.3.5. Use caution when driving near the edge of a ditch or gully. It may cave in, causing the tractor to roll over.

2.3.6. Be especially alert when operating near trees, slopes, and around obstructions.

2.4 Maintenance Safety

2.4.1. Ensure all hose connections are tight, and lines and hoses undamaged. Before disconnecting heater or air conditioner lines, relieve all pressure.

2.4.2. Remove mud, crop residue, chains, and tools from steps and operator's platform. They may interfere with pedal operation or entry/exit from tractor.

2.4.3. When servicing components are too high to reach from the ground use steps and handholds. Do not use fenders or shields that are not designed as steps.

2.5 Safe Highway Operation

2.5.1. Before operating tractor on, or near, public roadways, check with authorities for local regulations.

2.5.2. Equip towed implements with slow moving vehicle (SMV) signs when traveling on public roads.

2.5.3. Install additional lights on implement rear to safeguard against rear end collisions.

2.5.4. Use hazard warning flashers as required by law when transporting or driven on public roads. If the tractor warning flashers were removed when mounting the cab they must be replaced prior to operation on public roads.

2.5.5. Keep to the right, yielding right-of-way traffic, especially when pulling implements. Pull off the road and stop to allow motorists to pass. Drive on the road shoulder, if permitted by law.

2.5.6. Use extreme caution when pulling heavy loads at road speeds. Avoid hard application of the tractor brakes at high speed.

2.5.7. Always drive slowly near curbs, approaches, or ditches.

2.5.8. Ensure headlights are aligned so they will not blind the operator's of oncoming vehicles. If the tractor is not equipped with turn signals, and law requires them, install them prior to operating on or near public roads.

2.5.9. Use your turn signals, checking for traffic well in advance of turning. If the tractor is not equipped with turn signals, and law requires them, install them prior to operating on or near public roads.

2.6 Safety decals

2.6.1. Keep decals clean. Remove dirt with a wet clean cloth when necessary.

2.6.2. Replace safety decals if destroyed, missing, painted over, or unreadable. IF the tractor safety decals are covered, or obscured when the cab is mounted,

purchase replacement decals from the tractor manufacturer. Mount them in a readable location at, or near, their original location before operating the tractor.

2.6.3. New BOXER cab decals and tractor decals are available from your tractor dealer.

2.7 Emergency Exits

The this BOXER cab has two exits which may be used in an emergency: left side door, and right side door.

3.0 Operating Instructions

IMPORTANT

The following section locates, identifies, and briefly describes the functions of all cab controls. All operators should familiarize themselves with control location and function prior to operating the tractor. Failure to do so may result in unsafe operation of the tractor and possible injury or death to operators and bystanders.

3.1 Switchplate Controls

The switchplate is located on the headliner console which is just to the right of the operator, if so equipped.

1. Front Worklight Switch (optional)

Rocker switch

Low position: Off

High Position: On

2. Rear Worklight Switch (optional)

Rocker switch

Low position: Off

High position: On

3. Front Wiper Switch (optional)

Rocker switch

Low position: Low

Centre position: Off

High position: Washer*

* if equipped with windshield washer option only/momentary switch otherwise

4. Hazard/Beacon Switch (optional)

Rocker switch

Low position: Off

High position: On

5. Turn Signal Lever (optional)

Left position: Left

Right position: Right

3.2 Other Controls

1. Domelight (optional)

The domelight is located in the centre of the headliner console. It is adjustable to direct light where required.

Rocker switch

Low position: Off

High position: On

2. Heater Switch (optional)

Rotating switch

Set position: Off

Heating position: As knobs turns counter-clockwise, temperature rises

3. Fan Switch (optional)

Rotating switch

Set position:	Off
First position:	Low
Second position:	Medium
Third position:	High

4. Louvers (optional)

The louvers are located on the fascia of the heater console cover. They are adjustable to direct air flow where required.

4.0 Post-Mounting Instructions

Before starting a tractor equipped with a BOXER cab:

1. Clear the cab and tractor of all tools. Tools left in or around the cab and tractor can cause operator interference which could lead to bodily injury and/or damage to the machine.
2. Inspect the cab and tractor to ensure all bolts, screws, and heater connections are tight.
3. Ensure that all pedals, levers, and controls have adequate clearance for normal operation.
4. Ensure that all electrical components of both the cab and tractor operates normally.

Start the tractor and run standing at idle for a few minutes. Operate all pedals, levers, and controls checking for adequate cab clearance. Then run standing at PTO rpm speed for approximately five minutes and stop the tractor.

1. Inspect the heaters connections for leaks. Tighten as required.
2. Ensure that the water level in the tractor is to the required specification.

5.0 *Trouble Shooting*

In the following section, Jodale Perry has listed many of the problems, main causes, and practical solutions to the problems you may encounter. If you encounter a problem that is difficult to solve, contact your Jodale Perry dealer.

Problem	Cause	Solution
Too little heat	Air lock in system	Bleed air out of system
	Poor motor circulation	Install auxiliary pump
Poor wiper coverage	Wipe angle too narrow	Increase wipe angle on motor
Wiper blade contacts cab frame	Wipe angle too wide	Decrease wiper angle on motor

MAINTENANCE

ALWAYS USE GENUINE PARTS WHEN REPLACEMENT PARTS ARE REQUIRED.

1. Keep the tractor and cab properly maintained.
2. Park the tractor/cab on level ground, place the transmission in neutral, set the parking brake, disengage the PTO, lower all tractor attachments to the ground, place all control levers in neutral, shut off the engine and remove the ignition key and allow all moving parts to stop BEFORE making any tractor/cab adjustments.
3. To avoid injury, do not adjust, unblock the driving system, or service the cab with the tractor engine running. Make all moving parts have completely stopped before leaving the operator's seat.
4. Keep the tractor/cab clean. Snow, dirt, or ice build-up can lead to malfunction or personal injury from thawing and refreezing in the garage.
5. Always wear eye protection when cleaning or servicing the cab.
6. DO NOT service the tractor while the engine is running or hot, or if the unit is in motion. Always lower tractor attachments to the ground. If necessary to service attachments in raised position, securely support with stands or suitable blocking before working underneath. Do not rely on hydraulically supported devices for your safety. They can settle suddenly, leak down, or be accidentally lowered.
7. Do not attempt to service machine, clear obstructions, or unclog drive system with the engine running. Always shut off engine and allow all motion to cease.
8. The manufacturer will not claim responsibility for fitment of unapproved parts and/or accessories and any damages as a result of their use.
9. Make sure all shields and guards are securely in place following all service, cleaning, or repair work.
10. Do not modify or alter cab or any of its components or operating functions. If you have any questions concerning modifications, consult with your dealer.
11. Do not operate a cab that is defective or has missing parts. Make sure all recommended maintenance procedures are completed before operating cab.
12. Check all controls regularly and adjust where necessary. Make sure that the brakes are evenly adjusted.
13. Periodically check all nuts and bolts for tightness, especially wheel hub and rim nuts.
14. To avoid serious personal injury: Escaping hydraulic/diesel fluid under pressure can penetrate the skin causing serious injury. Do not use your hands to check for leaks. Use a piece of cardboard or paper to search for leaks.
15. Stop engine and relieve pressure before connecting or disconnecting hydraulic hoses. Tighten all connections before starting engine or pressurizing hoses.
16. Ensure cab hinges are properly lubricated. If hinges are closing hard, or partially seized, lubrication is required. Remove door/escape window/side vent windows to grease each part of the hinge separately. This should occur semi-annually.

6.0 *Assembly*

The following section consists of component breakdowns of the standard and optional parts contain in the Jodale Perry BOXER Pro Gator cab. For your convenience, part numbers have been assigned to those items, which may be ordered from Jodale Perry. If a required item doesn not have a part number associated with it, the part, with an associated part number, which contains that item must be ordered.

NOTE:

Each figure is only a general depiction of a cab and its components, and may noy appear exactly the same as the cab you have received.

Figure key:

A/R	-as required
LF	-linear foot
SF	-square foot
TU	-tube
U	-unit

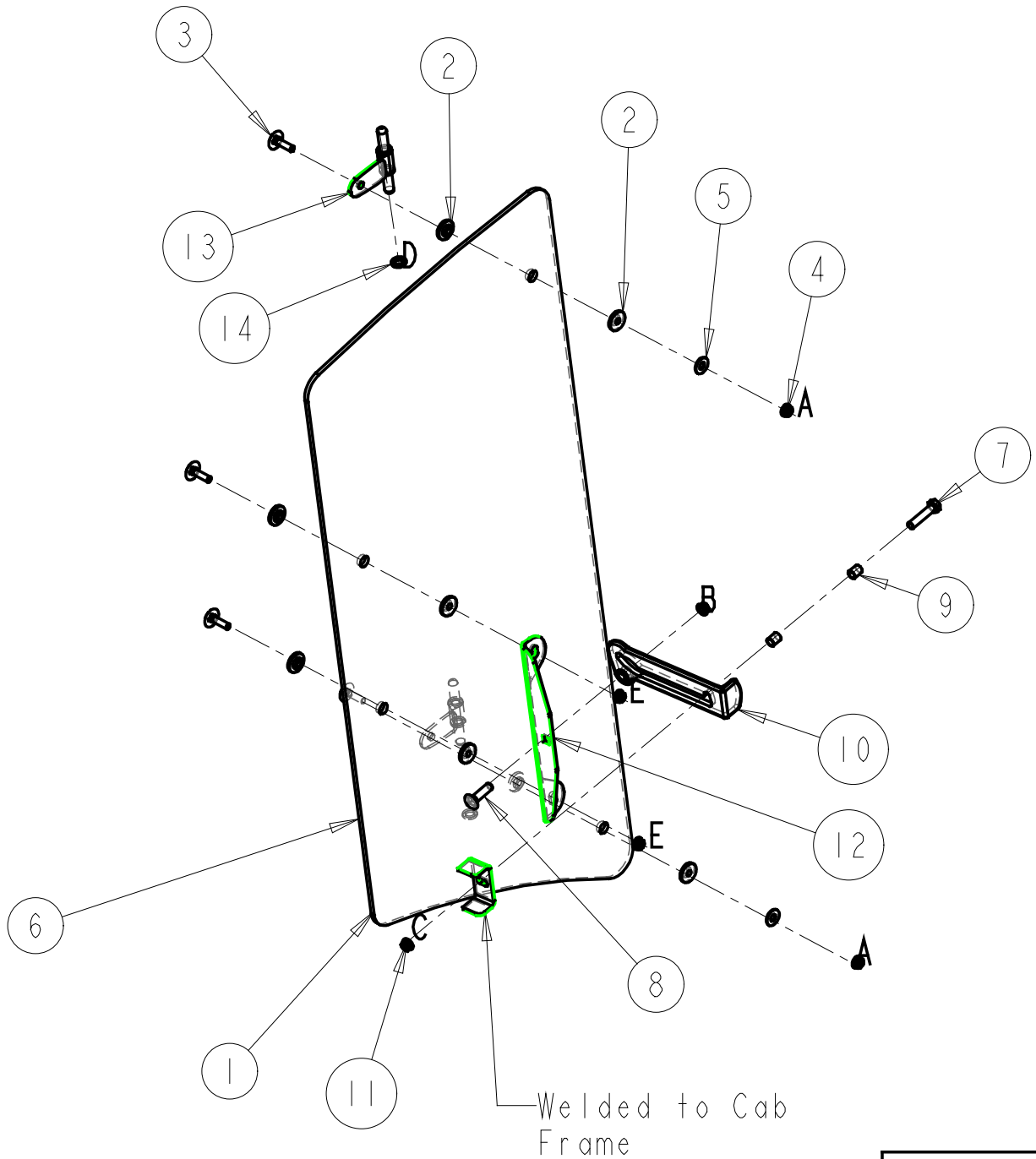

SCALE 0.150

Figure	Boxer Side Window
--------	-------------------

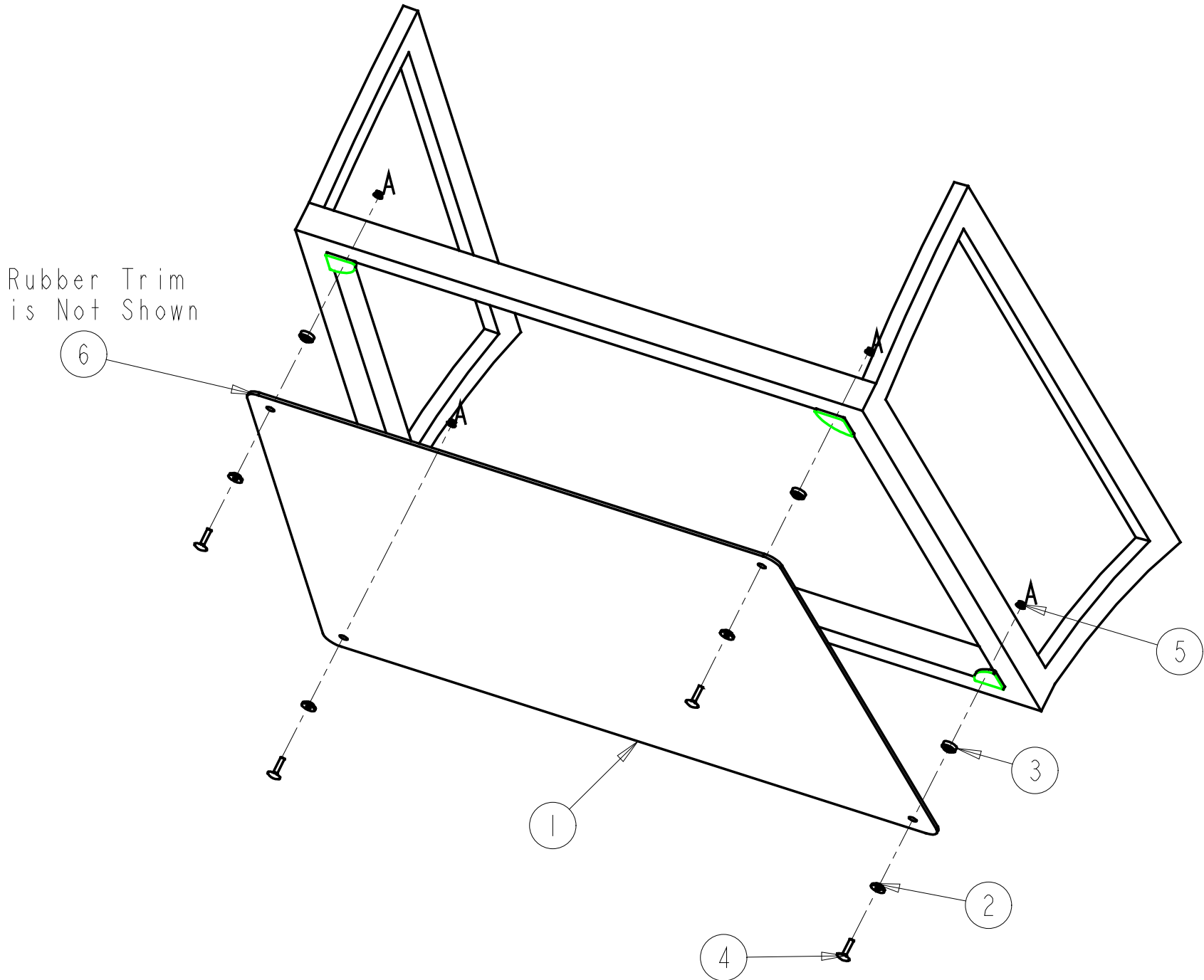

Rubber Trim
is Not Shown

6

1

4

2

3

5

Figure Boxer Rear Window

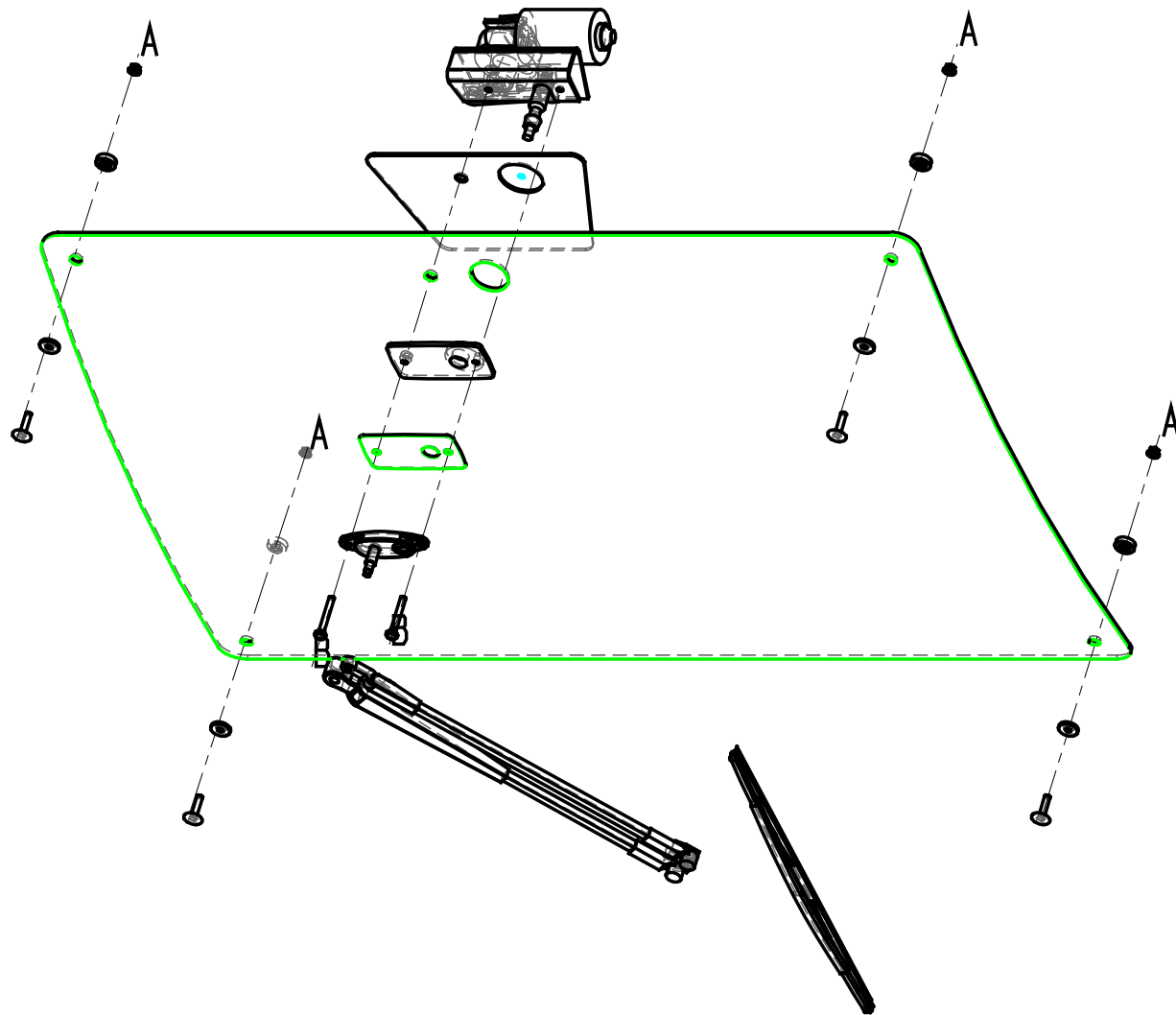

Figure | Windshield

Item #	JDP Part #	Assembly	Sub-Assembly	Description	Material Description	Qty.	Size	Unit
		Cab Fasteners						
	100737			Cab Mount Fasteners	Bolt, Flange, 7/16" x 2", Gr. 8, Yellow Dichrome	2	1.000	U
	100763			Cab Mount Fasteners	Nut, Flange, 7/16", Gr. 8, Yellow Dichrome	2	1.000	U
	100431			Cab Mount Fasteners	Washer, Flat, Steel, 1/2", Gr. 8, Yellow Dichrome	4	1.000	U
Item #	JDP Part #	Assembly	Sub-Assembly	Description	Material Description	Qty.	Size	Unit
		Windshield Assembly						
	100746			Windshield Glass	Glass, Tempered, 5MM, Green Tint, Bent	1	1.000	U
	100358			Glass Weatherstrip	Rubber, Clip-on, Double Bulb	1	13.475	LF
	100382			Window Glass Bushing	Bushing, Rubber, 5MM	4	1.000	U
	100381			Window Glass Bushing	Bushing, Rubber, 8MM	4	1.000	U
	100383			Glass Fastener	Bolt, Step, 1/4" x 1 1/4", Macro-black	4	1.000	U
	100223			Glass Fastener	Nut, Flange, 1/4", Macro-black	4	1.000	U
Item #	JDP Part #	Assembly	Sub-Assembly	Description	Material Description	Qty.	Size	Unit
		Left Door Assembly						
1	100747			Door Glass	Glass, Tempered, 5MM, Greylite Tint	1	1.000	U
2	100358			Glass Weatherstrip	Rubber, Clip-on, Double Bulb	1	13.292	LF
3	100382			Window Glass Bushing	Bushing, Rubber, 5MM	7	1.000	U
4	100362			Boxer Door Glass Bushing	Bushing, Rubber, 5MM, Inj-Molded, 3" Hole Centre	4	1.000	U
	100761			Lower Left Door Kick Panel	Plastic, Luran-S, 0.125"W, Black	1	1.000	U
5	100003			Glass Fastener	Bolt, Step, 1/4" x 1", Macro-black	3	1.000	U
6	100635			Glass Fastener	Bolt, Step, 1/4" x 1 1/2", Macro-black	4	1.000	U
7	100223			Glass Fastener	Nut, Flange, 1/4", Macro-black	6	1.000	U
9	100749			Door Grab Bar Weldment	Weldment	1	1.000	U
10	100750			Left Door Latch Weldment	Weldment	1	1.000	U
	100012			Striker Plate	Plate, 3/16"	1	1.000	U
	100384			Striker Plate Fasteners	Bolt, Flange, 1/4" x 1/2", Yellow Dichrome	2	1.000	U
	100013			Striker Pin	Pin, Striker (Included w/Latch)	1	1.000	U
	100014			Striker Pin Nut	Nut, Striker (Included w/Latch)	1	1.000	U
11	100006			Door Latch	Latch, Door, Interior, Left	1	1.000	U
12	100009			Door Push Button Handle	Handle, Exterior, Black	1	1.000	U
13	100011			Door Gasket	Rubber, Injection Molded	1	1.000	U
14	100369			Push Button Hande Extension Bolt	Bolt, Hex, 1/4" x 2 1/2" UNC, Plated	1	1.000	U
15	100007			Door Latch Fasteners	Bolt, Flange, M6 x 1.0 x 25MM, Yellow Dichrome	5	1.000	U
16	100008			Door Latch Fasteners	Nut, Flange, M6, Yellow Dichrome	2	1.000	U
	100365			Gas Shock	Shock, 40LB	1	1.000	U

	100366			Gas Shock Stud	Stud, 10mm	2	1.000	U
	100367			Gas Shock End Clip	Clip, Spring	2	1.000	U
19	100005			Gas Shock Stud Fastener	Nut, Serrated, Flange, 5/16", Yellow Dichrome	1	1.000	U
17	100368			Left Gas Shock Mount Plate	Plate, 3/16"	1	1.000	U
18	100748			Door Hinge Support Weldment	Weldment	1	1.000	U
20	100377			Left Door Hinge Weldment	Hinge, Weldment	2	1.000	U
21	100026			Hinge Brass Flat Washer	Washer, Brass	2	1.000	U
Item #	JDP Part #	Assembly	Sub-Assembly	Description	Material Description	Qty.	Size	Unit
		Right Door Assembly						
	100747			Door Glass	Glass, Tempered, 5MM, Greylite Tint	1	1.000	U
	100358			Glass Weatherstrip	Rubber, Clip-on, Double Bulb	1	13.292	LF
	100382			Window Glass Bushing	Bushing, Rubber, 5MM	7	1.000	U
	100362			Boxer Window Glass Bushing	Bushing, Rubber, 5MM, Inj-Molded, 3" Hole Centre	4	1.000	U
	100762			Lower Right Door Kick Panel	Plastic, Luran-S, 0.125"W, Black	1	1.000	U
	100003			Glass Fastener	Bolt, Step, 1/4" x 1", Macro-black	3	1.000	U
	100635			Glass Fastener	Bolt, Step, 1/4" x 1 1/2", Macro-black	4	1.000	U
	100223			Glass Fastener	Nut, Flange, 1/4", Macro-black	6	1.000	U
	100749			Door Grab Bar Weldment	Weldment	1	1.000	U
	100751			Right Door Latch Weldment	Weldment	1	1.000	U
	100012			Striker Plate	Plate, 3/16"	1	1.000	U
	100384			Striker Plate Fasteners	Bolt, Flange, 1/4" x 1/2", Yellow Dichrome	2	1.000	U
	100013			Striker Pin	Pin, Striker (Included w/Latch)	1	1.000	U
	100014			Striker Pin Nut	Nut, Striker (Included w/Latch)	1	1.000	U
	100006			Door Latch	Latch, Door, Interior, Right	1	1.000	U
	100009			Door Push Button Handle	Handle, Exterior, Black	1	1.000	U
	100011			Door Gasket	Rubber, Injection Molded	1	1.000	U
	100369			Push Button Hande Extension Bolt	Bolt, Hex, 1/4" x 2 1/2" UNC, Plated	1	1.000	U
	100007			Door Latch Fasteners	Bolt, Flange, M6 x 1.0 x 25MM, Yellow Dichrome	5	1.000	U
	100008			Door Latch Fasteners	Nut, Flange, M6, Yellow Dichrome	2	1.000	U
	100365			Gas Shock	Shock, 40LB	1	1.000	U
	100366			Gas Shock Stud	Stud, 10mm	2	1.000	U
	100367			Gas Shock End Clip	Clip, Spring	2	1.000	U
	100005			Gas Shock Stud Fastener	Nut, Serrated, Flange, 5/16", Yellow Dichrome	1	1.000	U
	100368			Right Gas Shock Mount Plate	Plate, 3/16"	1	1.000	U
	100748			Door Hinge Support Weldment	Weldment	1	1.000	U
	100378			Right Door Hinge Weldment	Hinge, Weldment	2	1.000	U

Item #	JDP Part #	Assembly	Sub-Assembly	Description	Material Description	Qty.	Size	Unit
	100026			Hinge Brass Flat Washer	Washer, Brass	2	1.000	U
Left Side Window Assembly								
1	100752			Side Glass	Glass, Tempered, 5MM, Greylite Tint	1	1.000	U
2	100382			Window Glass Bushing	Bushing, Rubber, 5MM	8	1.000	U
3	100003			Glass Fastener	Bolt, Step, 1/4" x 1", Macro-black	4	1.000	U
4	100223			Glass Fastener	Nut, Flange, 1/4", Macro-black	4	1.000	U
5	100380			Glass Fastener	Washer, Flat, 1/4"Wide, Yellow Dichrome	2	1.000	U
6	100358			Glass Weatherstrip	Rubber, Clip-on, Double Bulb	1	7.242	LF
7	100376			Side Window Slide Bolt	Bolt, Hex, 5/16" x 1 1/2", Yellow Dichrome	1	1.000	U
8	100374			Pin Slide Bolt	Bolt, Carriage, 5/16" x 1", Yellow Dichrome	1	1.000	U
9	100033			Latch Bushing	Bushing, Latch	2	1.000	U
10	100027			Window Latch Slider	Latch, Left, Interior	1	1.000	U
11	100005			Window Latch Pin Nut	Nut, Serrated, Flange, 5/16", Yellow Dichrome	2	1.000	U
12	100753			Side Window Arm Bracket - 1 1/2"	Sheet, 10GA	1	1.000	U
13	100379			Side Window Hinge Weldment	Hinge, Weldment	2	1.000	U
14	100026			Hinge Brass Flat Washer	Washer, Brass	4	1.000	U
Right Side Window Assembly								
	100752			Side Glass	Glass, Tempered, 5MM, Greylite Tint	1	1.000	U
	100382			Window Glass Bushing	Bushing, Rubber, 5MM	8	1.000	U
	100003			Glass Fastener	Bolt, Step, 1/4" x 1", Macro-black	4	1.000	U
	100223			Glass Fastener	Nut, Flange, 1/4", Macro-black	4	1.000	U
	100380			Glass Fastener	Washer, Flat, 1/4"Wide, Yellow Dichrome	2	1.000	U
	100358			Glass Weatherstrip	Rubber, Clip-on, Double Bulb	1	7.242	LF
	100376			Side Window Slide Bolt	Bolt, Hex, 5/16" x 1 1/2", Yellow Dichrome	1	1.000	U
	100374			Pin Slide Bolt	Bolt, Carriage, 5/16" x 1", Yellow Dichrome	1	1.000	U
	100033			Latch Bushing	Bushing, Latch	2	1.000	U
	100028			Window Latch Slider	Latch, Right, Interior	1	1.000	U
	100005			Window Latch Pin Nut	Nut, Serrated, Flange, 5/16", Yellow Dichrome	2	1.000	U
	100753			Side Window Arm Bracket - 1 1/2"	Sheet, 10GA	1	1.000	U
	100379			Side Window Hinge Weldment	Hinge, Weldment	2	1.000	U
	100026			Hinge Brass Flat Washer	Washer, Brass	4	1.000	U
Rear Window Assembly								
1	100754			Rear Glass	Glass, Tempered, 5MM, Greylite Tint	1	1.000	U

2	100382			Window Glass Bushing	Bushing, Rubber, 5MM	6	1.000	U
3	100381			Window Glass Bushing	Bushing, Rubber, 8MM	6	1.000	U
4	100383			Glass Fastener	Bolt, Step, 1/4" x 1 1/4", Macro-black	6	1.000	U
5	100223			Glass Fastener	Nut, Flange, 1/4", Macro-black	6	1.000	U
6	100358			Glass Weatherstrip	Rubber, Clip-on, Double Bulb	1	11.236	LF
Item #	JDP Part #	Assembly	Sub-Assembly	Description	Material Description	Qty.	Size	Unit
		Composite Panels						
	100755			Left Side Body Panel	Plastic, Luran-S, 0.125"W, Deere Green	1	1.000	U
	100756			Right Side Body Panel	Plastic, Luran-S, 0.125"W, Deere Green	1	1.000	U
	100757			Front Fascia Upper	Plastic, Luran-S, 0.125"W, Deere Green	1	1.000	U
	100758			Interior Left Side Panel	Plastic, Luran-S, 0.125"W, Black	1	1.000	U
	100759			Interior Right Side Panel	Plastic, Luran-S, 0.125"W, Black	1	1.000	U
	100436			DomeTag BOXER Logo	Sticker, Logo, Large, Yellow	1	1.000	U
	100443			Body Panel Fasteners	Screw, Pan Head, #8 x 3/4", Macro-black	25	1.000	U
	100510			Warning Decal	Narrow Size	1	1.000	U
	100511			Caution Decal	Narrow Size	1	1.000	U
	100512			Serial Decal	Aluminum, Adhesive	1	1.000	U
	100513			Hearing Decal	Narrow Size	1	1.000	U
Item #	JDP Part #	Assembly	Sub-Assembly	Description	Material Description	Qty.	Size	Unit
		Roof/Striker Assembly						
	100760			Roof w/Black Insert	Plastic, Luran-S, John Deere Green, 0.220"W	1	1.000	U
	100381			Window Glass Bushing	Bushing, Rubber, 8MM	4	1.000	U
	100441			Upper Roof Bolt	Screw, Button Head, 1/4" x 1", Macro-black	4	1.000	U
	100380			Roof Fastener Flat Washer	Washer, Flat, 1/4"Wide, Yellow Dichrome	4	1.000	U
	100042			Roof Fastener Nuts	Nut, Extruded, Panel, 1/4"	4	1.000	U
	100365			Gas Shock	Shock, 40LB	2	1.000	U
	100367			Gas Shock End Clip	Clip, Spring	4	1.000	U
	100012			Striker Plate	Plate, 3/16"	2	1.000	U
	100431			Striker Pin Washer Spacer	Washer, 1/2", Gr. 8	2	1.000	U
	100013			Striker Pin	Pin, Striker	2	1.000	U
	100384			Striker Plate Fasteners	Bolt, Flange, 1/4" x 1/2", Yellow Dichrome	4	1.000	U
	100478			Lift Hole Plug Buttons	Button, Plug, 3/8" Diam	2	1.000	U
	100014			Striker Pin Nut	Nut, Striker	2	1.000	U